

MAY 1997

OAKTON LAKES R.P.D.

SHEET 9 OF 10

41

(A RESIDENTIAL PLANNED DEVELOPMENT)
LYING AND BEING IN SECTION 20, TOWNSHIP 43 SOUTH, RANGE 42 EAST, CITY OF WEST PALM BEACH, PALM BEACH COUNTY, FLORIDA

(SEE SHEET 8 of 10)

MATCH LINE

TRACT "A"

TRACT "F"

WEST ONE-QUARTER CORNER
SECTION 20/43/42
FOUND HEX BOLT IN CONCRETE

NOT PLATTED
WEST LINE OF SECTION 20/43/42
S03°20'08"W 2452.03'
1052.03'

TRACT "F"

TRACT "A"

MATCH LINE
(SEE SHEET 4 of 10)

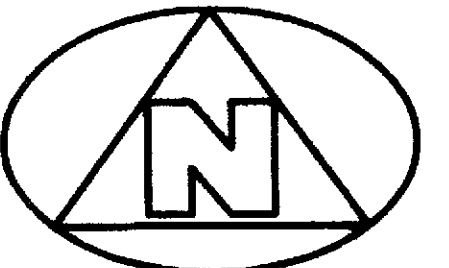

0 50' 100' 200'
GRAPHIC SCALE
(IN FEET)

MATCH LINE
(SEE SHEET 10 of 10)

TRACT "F"

TRACT "A"

MATCH LINE
(SEE SHEET 10 of 10)

C/L OF TEMPORARY
30' INGRESS/EGRESS EASEMENT
(O.R.B. 7953, PG. 1585)

TRACT "D"

SURVEYOR'S NOTES AND LEGEND:

1. THE BASE BEARING (MB) FOR THIS PLAT IS THE ASSUMED BEARING OF S08°44'50"E ALONG THE SOUTH LINE OF THE SOUTHWEST ONE-QUARTER OF SECTION 20, TOWNSHIP 43 EAST, RANGE 42 EAST, AND ALL OTHER BEARINGS ARE RELATIVE THERETO.
2. C/L DENOTES A CENTERLINE
3. DENOTES A SET #2424 PERMANENT REFERENCE MONUMENT (P.R.M.)
4. P.B.CO. DENOTES PALM BEACH COUNTY

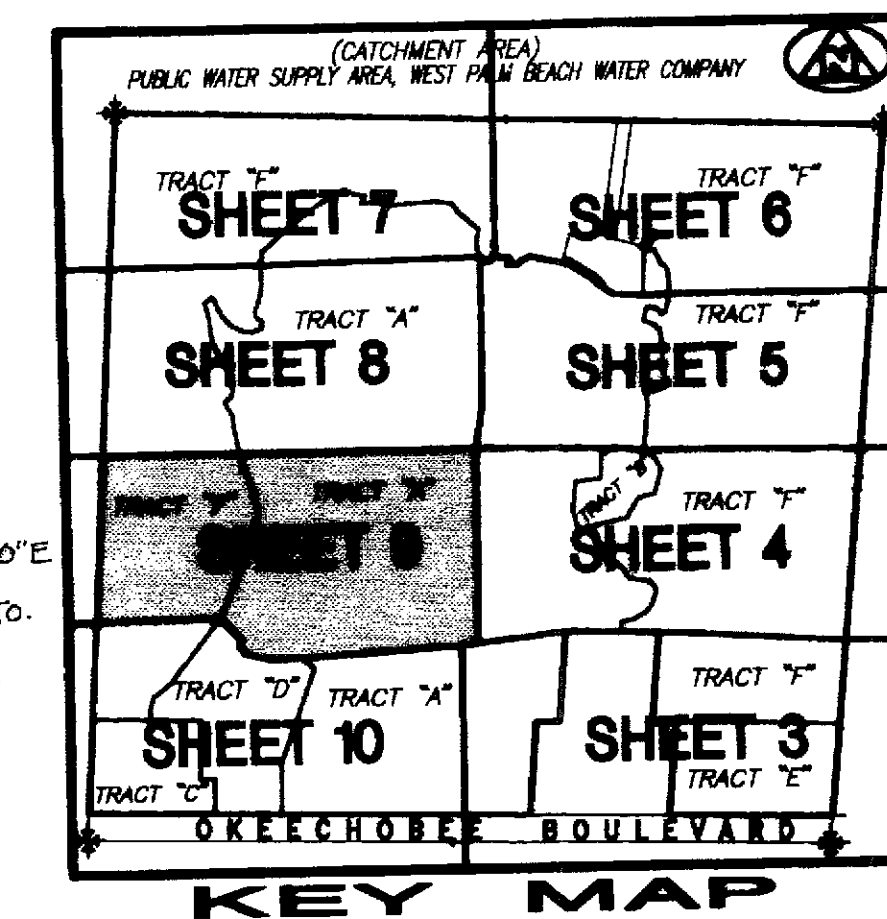

THIS INSTRUMENT WAS PREPARED BY WM. R. VAN CAMPEN, R.L.S., IN AND FOR THE OFFICES OF BENCH MARK LAND SURVEYING & MAPPING, INC., 4152 WEST BLUE HERON BOULEVARD, SUITE 121, RIVIERA BEACH, FLORIDA

BENCH MARK
Land Surveying and Mapping, Inc.
4152 West Blue Heron Blvd., Suite 121, Riviera Beach, FL 33404
Fax (407) 844-9659 Phone (407) 848-2102

RECORD PLAT
OAKTON LAKES R.P.D.

DWN	D.M. & SEC.	FB	DATE	09/01/96	WO.#	P156
CKD	FILE	P156-A.dwg	SCALE	1" = 100'	SHEET	9 OF 10